

GENERAL FEATURES

- Electric Vehicle/Bike/Tricycle
- Electric Wheelchair
- Electric Scooter
- Electric play Car for children
- Garbage Truck
- Patrol Car

GENERAL FEATURES

- High Corrosion Resistant Performance: Pb-Camulti-alloy grid
- High Energy Density and Power Density
- Excellent Charge Acceptance Ability
- Strong High and Low-Temperature Performance
- Optimized Capability of instant High-current Discharging
- Low self-discharge rate

PERFORMANCE SPECIFICATIONS

Nominal Voltage	12V	
Nominal Capacity (2hour rate)	12Ah	
Design Life @25°C	5 years	
Terminal	M5	
Approx. Weight	3.95kg (8.72lbs)	
Container Material	ABS	
Rated Capacity	10 hour rate (1.54A to 10.5V)	14.0Ah
	2 hour rate (6.00A to 10.5V)	12.3Ah
	1 hour rate (10.5A to 10.5V)	11.5Ah
Discharge Temperature	-20~50°C	
Charge Temperature	-20~40°C	
Storage Temperature	-20~50°C	
Float use Charge (Constant Voltage) @25°C	13.6~13.9V	
Cycle Use Charge (Constant Voltage) @25°C	14.7~14.9V	
Maximum charging current	2.4A	
Self discharge @25°C	3% of capacity declined per month	

MEASUREMENT

Dimension: 151(L)×99(W) ×98(H)×98.5(TH) Unit: mm

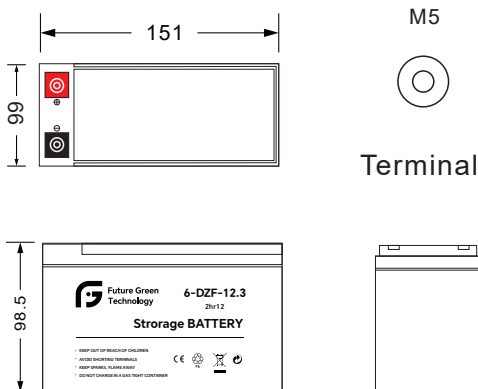

Constant Current Discharge Characteristics Unit: A (25°C, 77°F)

FV/Time	5min	15min	30min	1h	2h	3h	5h	8h	10h	20h
1.60V	55.80	30.00	18.000	11.800	6.330	4.350	2.680	1.720	1.450	0.772
1.65V	54.10	29.00	17.700	11.800	6.300	4.310	2.660	1.710	1.430	0.768
1.70V	51.90	28.40	17.400	11.700	6.250	4.250	2.630	1.690	1.420	0.763
1.75V	47.80	27.50	17.200	11.500	6.150	4.200	2.600	1.670	1.400	0.760
1.80V	42.80	25.60	16.500	11.200	6.040	4.170	2.530	1.620	1.390	0.756
1.85V	38.10	22.900	15.100	10.400	5.730	3.930	2.410	1.550	1.350	0.743

Constant Power Discharge Characteristics Unit: W/cell(25°C, 77°F)										
FV/Time	5min	15min	30min	1h	2h	3h	5h	8h	10h	20h
1.60V	93.80	52.80	32.600	22.400	11.900	8.290	5.090	3.340	2.780	1.520
1.65V	90.20	51.90	32.300	22.200	11.900	8.180	5.060	3.320	2.750	1.510
1.70V	99.30	51.30	32.300	22.000	11.900	8.130	5.020	3.300	2.730	1.510
1.75V	83.40	50.90	32.100	21.800	11.800	8.090	4.990	3.250	2.690	1.510
1.80V	76.60	48.10	31.300	21.700	11.700	8.060	4.930	3.160	2.670	1.500
1.85V	68.40	43.000	28.800	20.100	11.300	7.660	4.710	3.050	2.630	1.480

Disclaimer: Manufacturers have the right to self-modify the parameters of the product updates, please keep in touch with manufacturers to obtain the latest information.

Discharge characteristic

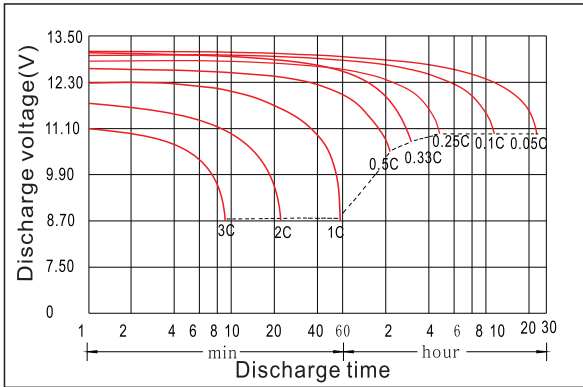

Charging characteristic

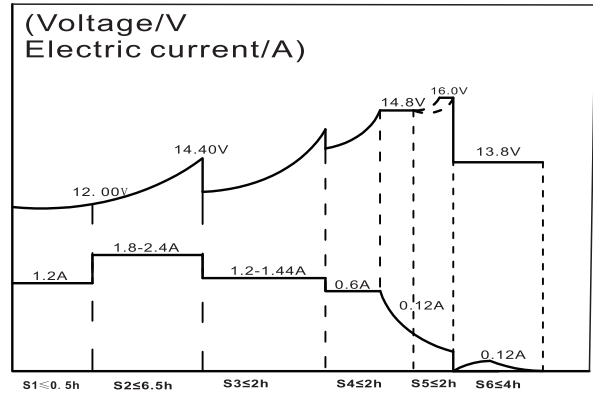

The effect of temperature on capacity

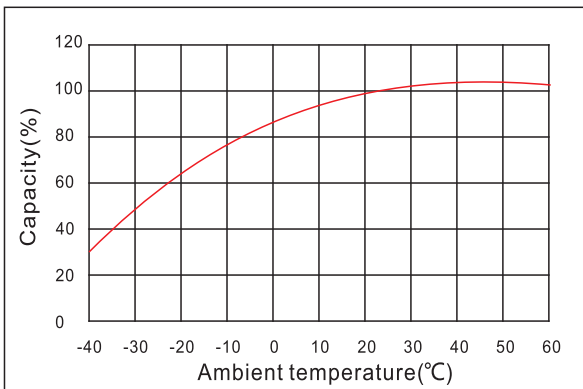

The effect of discharge depth on cycle life

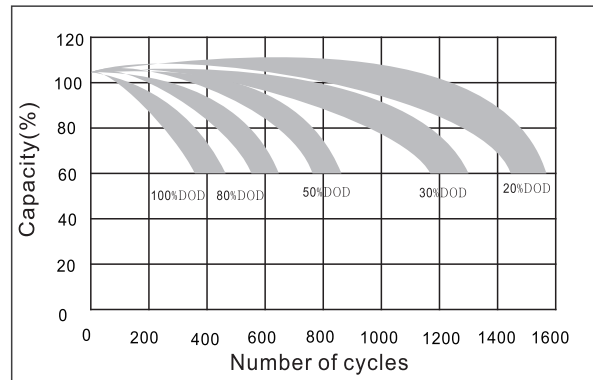

Curves of self-discharge

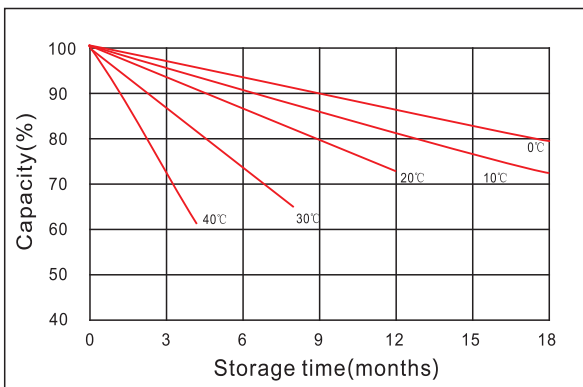

Curves of open circuit voltage vs. capacity

